

The Ray Allen Company Inc.

1341 Distribution Way Ste 15, Vista, CA 92081 USA Ph 760 599 4720 Fx 760 599 4383
www.rayallencompany.com



INSTALLING THE RBS SERIES BEZEL SWITCHES

Ray Allen RBS series Bezel Switches are designed to be mounted into the instrument panel as shown in **Figure 1**. This requires one rectangular hole to be cut out and four mounting screw holes to be drilled.

Figure 1

NOTE: SWITCH NOT SHOWN FOR CLARITY PURPOSES.
Switch should be mounted to front bezel before securing to instrument panel.

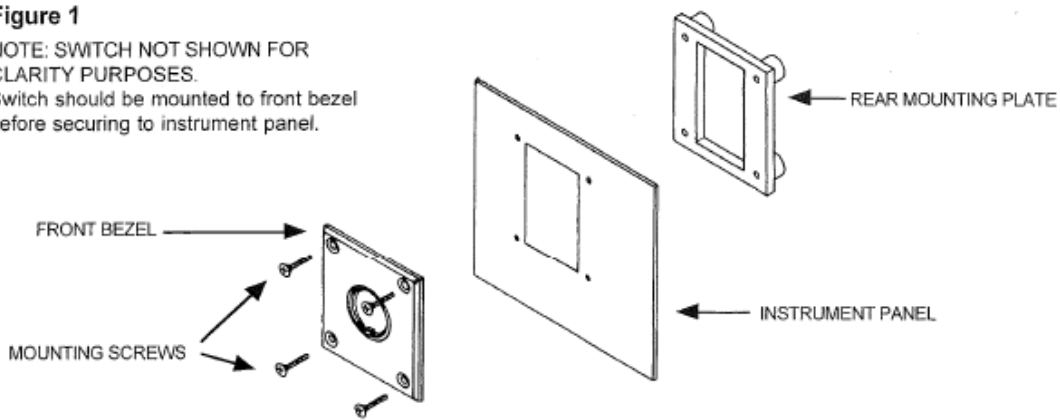

STEP 1 - ASSEMBLING THE FRONT BEZEL ON THE SWITCH

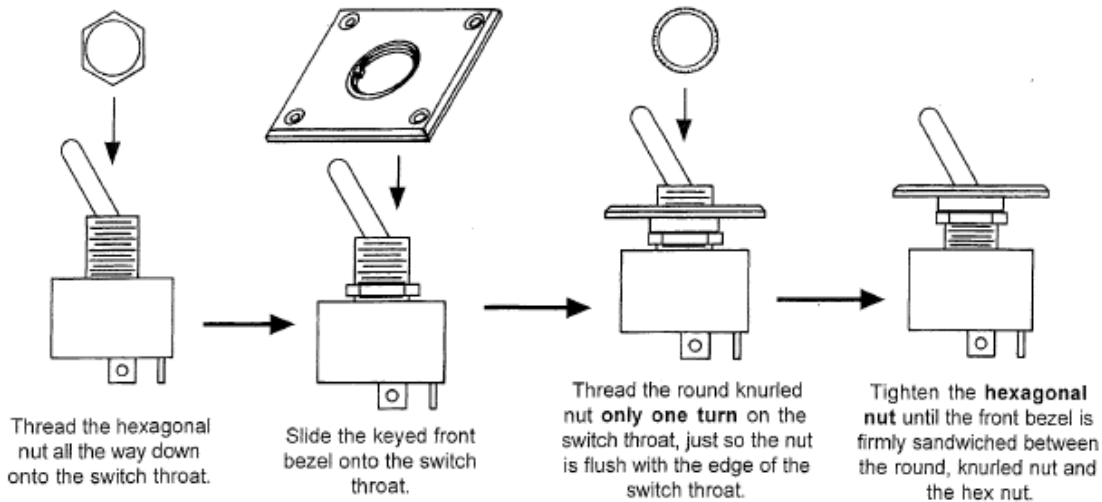

Warning: Installation and use of Ray Allen Company products is the responsibility of the aircraft designer and builder. Use of Ray Allen products in any application which will exceed their capability can cause failure leading to injury or death.

STEP 2 - ALIGNING THE SWITCHES

If you have more than one bezel switch to install, align the rear mounting plates together on your panel with a ruler (see **Figure 2**). The rear mounting plates have the same dimensions as the front mounting plate. You can align the rear mounting plates side by side if you don't want any spacing in between your bezel switches or leave a little space between the bezels if you think it looks best that way.

Figure 2

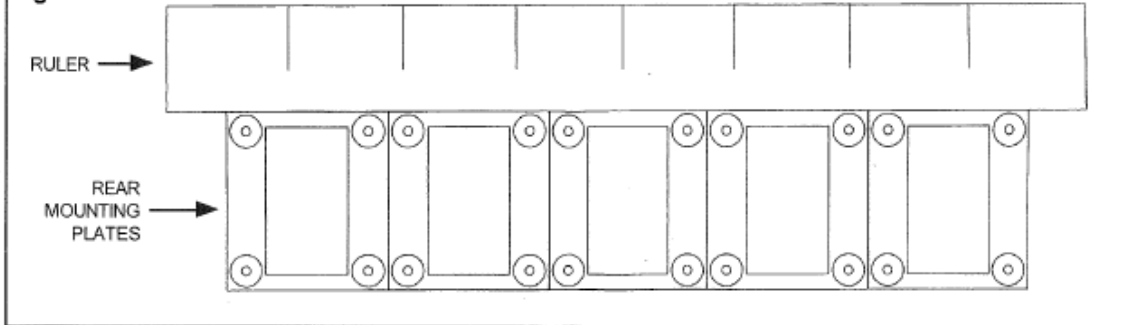

STEP 3 - MOUNTING SWITCH BEZEL TO INSTRUMENT PANEL

Use the aligned rear mounting plate(s) as a guide to mark the outline of the rectangular hole(s) to be cut out of the instrument panel.

The four screw holes in the rear mounting plate can be used as a drill guide, but be careful not to enlarge the holes in the plastic. Use no larger than a #48 drill (.076"). If the holes are enlarged, they won't be able to serve in their locking nut function.

After drilling the guide holes, remove the rear mounting plate and enlarge the holes in the instrument panel with a #44 drill, (.086"), so the screws can slip through.

Slide the switch through the instrument panel. This is a close fit. Removing the screws from the screw terminals will help (toggle switch only).

Secure the bezel and switch to the panel with the four 2/56 x 7/16" countersunk screws provided. These screws self tap into the rear mounting plate. It may be helpful to glue the rear mounting plate onto the rear of the instrument panel.

Secure your wires to the switch with the screws provided.

**RBS Series
PANEL CUT-OUT**

