

NOTES: UNLESS OTHERWISE SPECIFIED

1. MANUFACTURED AND INSPECTED IAW AS9100 QUALITY SYSTEM REQUIREMENTS.
2. ABBREVIATION USED IN TITLE IS: VALVE REGULATED SEALED LEAD ACID (VRSLA).
3. SEE DRAWING NO. CB-00447 AND PROCEDURE P-1000 FOR ASSEMBLY AND TEST INSTRUCTION. PROCEDURES AND ASSEMBLY DRAWINGS ARE FOR INTERNAL USE ONLY.
4. BATTERIES ARE RATED IAW INTERNATIONAL ELECTROTECHNICAL COMMISSION STANDARD 60952-1 AND RTCA STANDARD DO-293A, UNLESS OTHERWISE NOTED.

| REVISIONS | | | |
|-----------|-------------------------------------|---------|----------|
| REV | DESCRIPTION | DATE | APPROVED |
| A | 6.16 WAS 6.03 | 7/25/13 | JBT |
| B | REINSTATED RG-330, UPDATED TO 30 AH | 5/25/16 | PH |

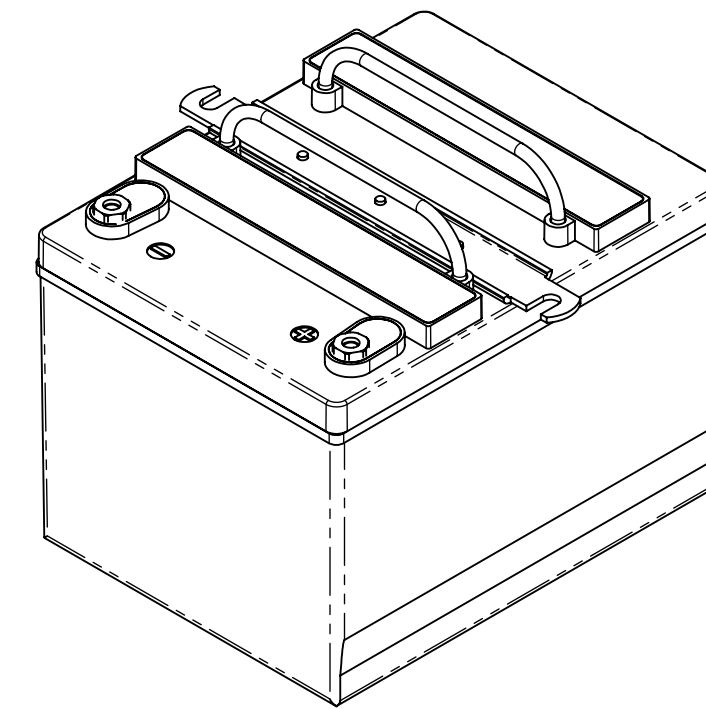
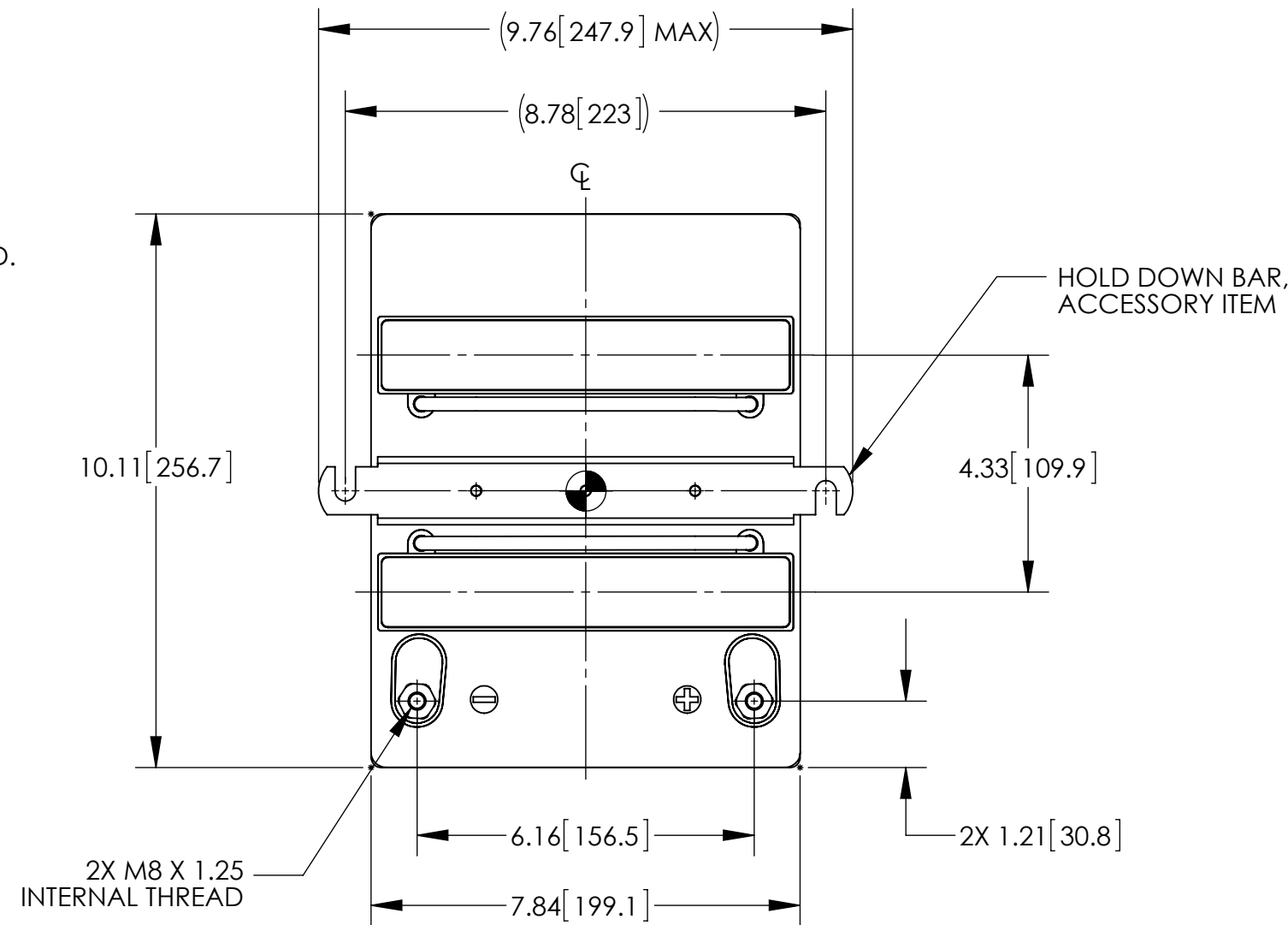

ISOMETRIC VIEW

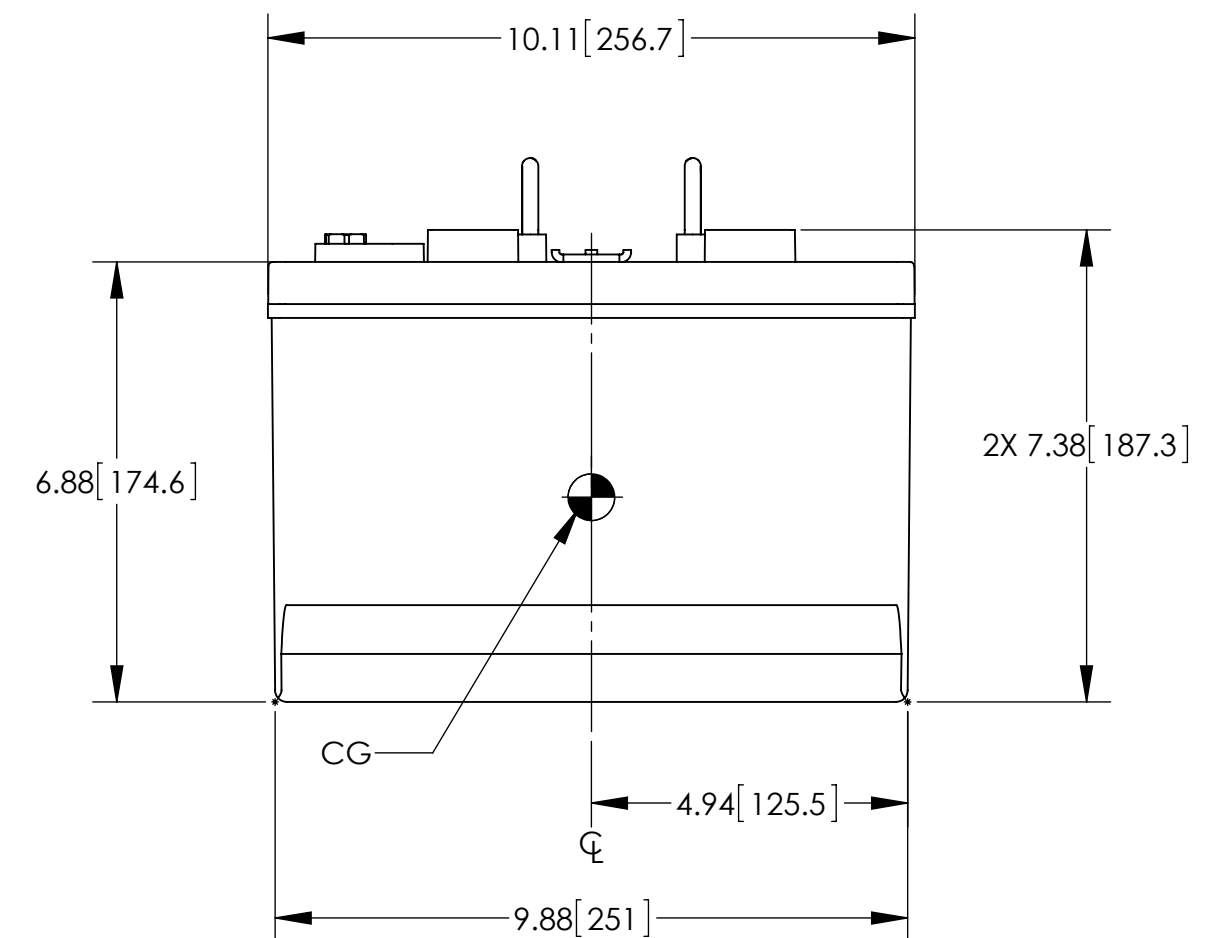
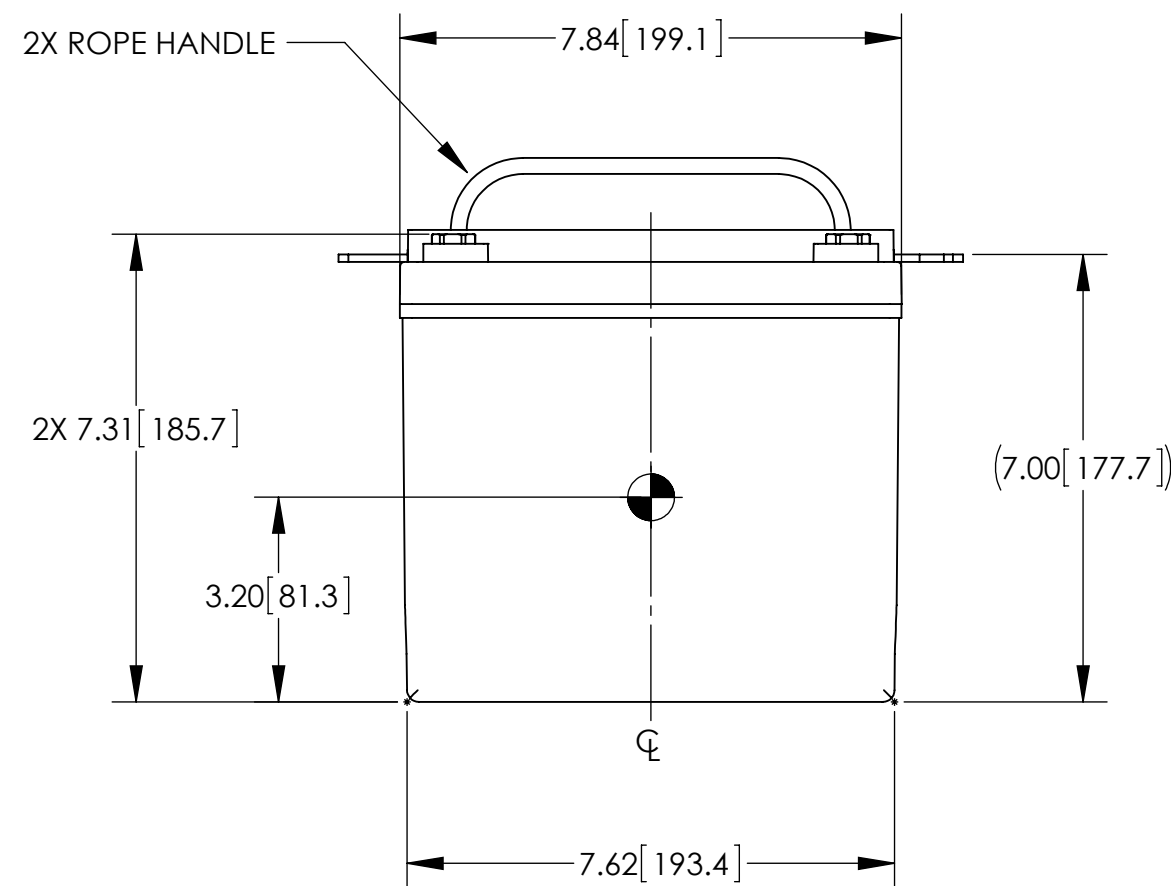

ENVELOPE DRAWING

| | |
|--------------------------------|------------------------|
| PART NUMBER | RG-330 |
| MAXIMUM WEIGHT | 61 LBS [27.7 KG] |
| RATED CAPACITY, C ₁ | 30 AH |
| POWER RATING AT 23 °C | lpp 1525 A, lpr 1100 A |
| POWER RATING AT -18 °C | lpp 1100 A, lpr 800 A |
| POWER RATING AT -30 °C | lpp 875 A, lpr 600 A |

| | | | | | | | |
|---|--------------------------|--------------|----------------|-----------|---|----------------|-------|
| UNLESS OTHERWISE SPECIFIED DIMENSIONS ARE IN INCHES TOLERANCES ARE: | | | CONTRACT NO. | | CONCORDE BATTERY CORPORATION 2009 SAN BERNARDINO RD, W. COVINA, CA 91790 | | |
| FRACTIONS | DECIMALS | ANGLES | APPROVALS | DATE | TITLE | | |
| ± 1/32 | .XX ± .06 .XXX ± .030 | ± 1° | DRAWN D. AYALA | 3/2/11 | BATTERY, VRSLA, 24 VOLT | | |
| TREATMENT | NONE | CHECKED NS | 3/2/11 | SIZE C | CAGE CODE 63017 | DWG NO. RG-330 | REV B |
| FINISH | NONE | APPROVED JBT | 3/3/11 | SCALE 1:3 | SHEET 1 OF 1 | | |
| SIMILAR TO | CALC WT | ISSUED JG | 5/27/16 | | | | |